



# Self Adhesive Tie Mounts

 [www.elektraefflux.in](http://www.elektraefflux.in)



- Designed to support wires bundles when properly applied on any clean smooth, grease- free surface.
- Cable Ties can be inserted from any of the four sides to secure wire bundles.
- Curved walls allow the wire bundles to seat firmly in position after installing with cable ties.
- To apply, simply peel off back liner paper and apply mount to surface.



# Self - Adhesive Tie Mount

**SGI Self-Adhesive Tie Mounts** are used to anchor wire bundles or cables to walls, ceilings, plates, panels, or any other structure. No tool is required for installation. Simply place the Adhesive-Backed Mount on the desired surface, and secure the cables with Cable-Ties.

The Continuous-Straight  
Pull Load is 1Kg/square  
inch (25.4mm) of adhesive.  
Operating Temperature  
for Adhesive: Upto 52°C

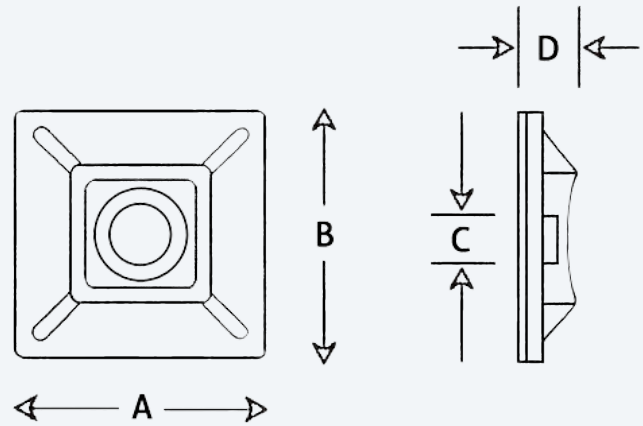

## DIMENSIONS

Item No.	Size Length x Width (in mm)	Product Code	Load Capacity	Tape	Std. Packaging
TM1919W	19 X 19	EE-6401	700-800 gms	German White	100 pcs Bag
TM2525W	25 X 25	EE-6402	1100-1200 gms	German White	100 pcs Bag
Material : Polyethylene . Colours Available : Natural Black					

